

2185

COMPILED LIST OF OWNERS AS AT: 27 January 1984
BLOCK: WHANGAWEHI 1B5B2A
TITLE: Partltion Order dated 3.11.1952
AREA: .7284 m² (1a: 3r: 08p)
NO. OF ORIGINAL OWNERS: 1

1. Rangi Waihaki ..10 Rgta 85 .. f. 288.00000 ²⁻¹¹
For life or until remarriage with
remainder equally to:-
Pera Waihaki .. f.
Peratiaki Waihaki .. m.
Mihi Kite Kapua
Vanderchaegue .. f.
Tama Arohanui Waihaki .. m.
Maheatanga Waihaki .. m.
Tewai Topsy Nathan .. f.
Alexa Merita Rauhina Spark .. f.
Brenda Witakirua Single .. f.
Patrick Te Ngaio Waihaki .. m.
Matekino Reid .. f.

TOTAL SHARES

288.00000

C

TITLE: P.O. dated 3.11.1982

BLOCK: Whangawhi 1BSBZA

AREA: 7284 m²

SHARES: 288.00000

(The orders themselves should be referred to for search purposes)

"DECEASED" OR
TRANSEEROR.

TRANSEEROR

11ST No

288 - 288 Registry MB
SHARES M.B. REF 68

115T No

SHARES

...M.B.:

Registry MB
68

ORDER

Sec. 127(2)/93

DATE _____

15:2:98

M.A. 835

74218H-10,000/7/27 MK

M.A. 801

45594
Page No. _____

Page No.

BLOCK: WHANGAWEHI 1B5B2A

NUMBER OF ORIGINAL OWNERS:

AREA. 1:3:08p

SHARES: 288.000

(The orders themselves should be referred to for search purposes)

M.A. 035

SCHEDULE OF OWNERSHIP ORDERS

TITLE: P.O. dated 3.11.1982

BLOCK: Whangawehi 18SB2A AREA: 7284 m² SHARES: 288.00000

(The orders themselves should be referred to for search purposes)

List No.	Owners	Sex and Age	Ratio	Shares in Block			Total	To
				Already Owned From	Number	Now Acquired Number		
								</

M.A. 835

74218H-10,000/7/87 MK

NAME OF BLOCK: WHANGAWEHI 1B5B2A

N.B. - The order or title notice should be referred to for search purposes.

-M.A. 801

RATE CHARGING ORDER SCHEDULE

VALUATION SHEET

BLOCK: WHANGAREHI 1B5B2A DISTRICT: Wairoa
 AREA: 7284 m2 TOTAL SHARES: 288.0000
 SURVEY DISTRICT: BLK II MAHIA Address of property: Parakawai RD.

VALUATION DETAILS

DATE:	LAND:	IMPTS:	DETAILS	CAPITAL:	VALUE ONE SHARE
1.7.88					
VALN REF:					
8701448	16000	50000		66000	\$229.1666
TOTAL					

Occupier (Within meaning of the rating act): _____ Checked: W.D.

DATE:	LAND:	IMPTS:	DETAILS	CAPITAL:	VALUE ONE SHARE
1.10.91					
VALN REF:					
8701448	29600	36500		66000	\$229.1666
TOTAL					

Occupier (Within meaning of the rating act): Karounga Waihaki Checked: W.D.

DATE:	LAND:	IMPTS:	DETAILS	CAPITAL:	VALUE ONE SHARE
1.9.91					
VALN REF:					
8701448	32000	58000	DRY DB DI FG	90000	\$312.50
TOTAL					

Occupier (Within meaning of the rating act): K. Waihaki Checked: B.J.R.

DATE:	LAND:	IMPTS:	DETAILS	CAPITAL:	VALUE ONE SHARE
1-9-97					
VALN REF:					
870044800	49000	86000	DWG DB OI FG	135000	\$468-75
TOTAL					

Occupier (Within meaning of the rating act): _____ Checked: W.D.

DATE:	LAND:	IMPTS:	DETAILS	CAPITAL:	VALUE ONE SHARE
VALN REF:					
TOTAL					

Occupier (Within meaning of the rating act): _____ Checked: _____

Total Area: 12.6337 Ha. Page No. 1
LEASING ORDERS 45608

Block: WHANGAWEHI 1B5B2B

NUMBER OF ORIGINAL OWNERS:

AREA: 30:2:32p

SHARES: 4912.000

(The orders themselves should be referred to for search purposes)

ENTERED BY Δ 22 CHECKED BY

SCHEDULE OF OWNERSHIP ORDERS

TITLE: Partition Order Dated 3.11.52

BLOCK: WHANGAWEHI 1B5B2B AREA: 12.6377 ha SHARES: 4912.000

(The orders themselves should be referred to for search purposes)

List No.	Owners	Sex and Age	Ratio	Shares in Block			Total	To
				Already Owned		Now Acquired Number		
				From	Number			
				DECEASED OR TRANSFEROR <u>Rapata Toko or Rapata Tok</u>				
				<u>Waihaki</u>				<u>86 OF 1</u>
				LIST No. <u>5</u> SHARES <u>1040.000</u> M.B. REF. <u>101-102</u>				
				ORDER <u>Sec 78A/62</u>				DATE <u>10.7.84</u>
8	Rapata Matemoana Toko	m.d.	1/3			80.000	80.000	
9	Theresa Toko	f.a.	1/3			80.000	80.000	
10	Douglas Martin Toko	m.a.	1/3			80.000	80.000	
11	Junette Francis Holt	f.a.	1/3			80.000	80.000	
12	William Claude Toko	m.a.	1/3			80.000	80.000	
13	Fay Marie Toko	f.a.	1/13			80.000	80.000	
14	Iritana Terauaroa Holt	f.a.	1/13			80.000	80.000	
15	Reginald Peter Toko	m.a.	1/13			80.000	80.000	21
16	McGregor Toko (16.4.67)	m.b.	1/13			80.000	80.000	26
17	Kevin Desmond Toko (17.5.68)	m.b.	1/13			80.000	80.000	22
18	Albina Faith Toko (20.11.69)	f.b.	1/13			80.000	80.000	23
19	James Andrew Toko (10.12.70)	m.b.	1/13			80.000	80.000	24
20	Lily Cecelia Toko (6.10.72)	f.b.	1/13			80.000	80.000	25
				ENTERED BY <u>Reginald Peter Toko And</u>				
				DECEASED OR TRANSFEROR <u>Kevin Desmond Toko</u>				
				LIST No. <u>15917</u> SHARES <u>160.000</u> M.B. REF. <u>107/25-25</u>				
				ORDER <u>sec 93/53</u>				DATE <u>10.7.84</u>
21	Reginald Peter Toko	m.	-			80.000	80.000	
22	Kevin Desmond Toko	m.	(17-5-68)			80.000	80.000	
	TRUSTEE: Douglas Martin Toko.			ENTERED BY <u>Reginald Peter Toko</u>				
				CHECKED BY <u>Reginald Peter Toko</u>				

M.A. 835

50082H--10,000/8/82MK

On 24.03.01 Road 2544-1
and amended 23.9.83

SCHEDULE OF OWNERSHIP ORDERS

FILE: P/O dated 3.11.53

BLOCK: WHANGAWEHI 18583B AREA: 12.63377 ha SHARES: 4912.000

(The orders themselves should be referred to for search purposes)

List No.	Owners	Sex and Age	Ratio	Shares in Block			To
				Already Owned		Now Acquired Number	
				From	Number		
				Albina Faith Toko And James DECEASED OR Andrew Toko And Lily Cecelia TRANSFEROR TOKO.			
				LIST No. 18, 19, 20 SHARES 240.000 M.B. REF. 14/7/53-25			
				ORDER SEC 93/53 DATE 10.7.84			
33	Albina Faith Toko	fb	(20-11-69)	-	-	80.000	80.000
34	James Andrew Toko	ms	(20-12-70)	-	-	80.000	80.000
35	Lily Cecelia Toko	fb	(6-10-72)	-	-	80.000	80.000
	TRUSTEE: Te Rerewaipuke Bowater.						
				ORDERED BY 32 CHECKED BY			
				DECEASED OR McGregor Toko			
				TRANSFEROR			
				LIST No. 16 SHARES 80.000 M.B. REF. 14/7/53-25			
				ORDER SEC 93/53 DATE 10.7.84			
36	McGregor Toko	ms	(16-4-91)	-	-	80.000	80.000
	TRUSTEE: Fay Marie Pohe.						
				ORDERED BY 32 CHECKED BY			
				CPC CHECKED 62			
	Recompiled to Dec 22/1977.						

M.A. 835

8862H-10,000/8/82MK

Ch. 27: 03.01: Wal 10.000
and amended 23.9.83

2186

COMPILED LIST OF OWNERS AS AT: 10 July 1984

BLOCK: WHANGAWEHI 1B5B2B

TITLE: Partition Order dated 3.11.1952

AREA: 12.6337 ha (30a: 2r: 32p)

NO. OF ORIGINAL OWNERS: 5

1.	Albina Falth Toko	147 Whanganui 22-25	f.	80.00000
2.	Ani Waihaki		f.	1040.00000
3.	Douglas Martin Toko	86 Oti 101-2	m.	80.00000
4.	Fay Marie Toko	86 Oti 101-2	f.	80.00000
5.	Hiria Waihaki		f.	1040.00000 ³⁰⁻³¹
6.	Iritana Terauaroa Holt	86 Oti 101-2	f.	80.00000
7.	James Andrew Toko	147 Whanganui 22-25	m.	80.00000
8.	Junette Francis Holt	86 Oti 101-2	f.	80.00000
9.	Kevin Desmond Toko	147 Whanganui 22-25	m.	80.00000
10.	Lily Cecelia Toko	147 Whanganui 22-25	f.	80.00000
11.	Mata or Mata Waihaki		f.	1040.00000 ²⁸⁻²⁹
12.	McGregor Toko	147 Whanganui 22-25	m.	80.00000
13.	Rangi Waihaki	10 Rgta 85	f.	752.00000 ³⁻²⁷
	<u>For life or until remarriage with</u>			
	<u>remainder equally to:-</u>			
	Pera Waihaki		f.	
	Peratiaki Waihaki		m.	
	Mihi Kite Kapua Vanderchaegue		f.	
	Tama Arohanui Waihaki		m.	
	Maheatanga Waihaki		m.	
	Tewai Topsy Nathan		f.	
	Alexa Merita Rauhina Spark		f.	
	Brenda Witakirua Single		f.	
	Patrick Te Ngaio Waihaki		f.	
	Matekino Reid		f.	
14.	Rapata Matemoana Toko	86 Oti 101-2	m.D.	80.00000
15.	Reginald Peter Toko	147 Whanganui 22-25	m.	80.00000
16.	Theresa Toko	86 Oti 101-2	f.	80.00000
17.	William Claude Toko	86 Oti 101-2	m.	80.00000
	TOTAL SHARES			<u>4912.00000</u>

SCHEDULE OF OWNERSHIP ORDERS

TITLE: P.O. dated 8/11/1962

BLOCK: Whangawehi 18582R AREA: 12.6837 ha SHARES: 442.0000

(The orders themselves should be referred to for search purposes)

(The orders themselves should be referred to for search purposes)								
List No.	Owners	Sex and Age	Ratio	Shares In Block			Total	To
				Already Owned		Now Acquired Number		
				From	Number			
	Rangi Waihaki For life or until remarriage with remainder equally to :- Pera Waihaki f. Peratiaki Waihaki m. Mihi Kite Kapua Vanderchaegue Tama Arohanui Waihaki m.f. Maheatanga Waihaki m. Tewai Topsy Nathan f. Alexa Merita Rauhinia Spark f. Brenda Witakirua Single f. Patrick Te Ngairo Waihaki f. Matekino Reid f.							
DECEASED OR TRANSFEROR				LIST No. 18	SHARES 752.00000	28	Register M.B. REF. 68	
ORDER Sec. 127(2)/98						DATE 25.2.98		
18	Pera Waihaki	f.	1/10		75.20000	75.20000		
19	Peratiaki Waihaki	m.	1/10		75.20000	75.20000		
20	Mihi Kite Kapua Vanderchaegue	f.	1/10		75.20000	75.20000		
21	Tama Arohanui Waihaki	m.	1/10		75.20000	75.20000		
22	Maheatanga Waihaki	m.	1/10		75.20000	75.20000		
23	Tewai Topsy Nathan	f.	1/10		75.20000	75.20000		
24	Alexa Merita Rauhinia Spark	f.	1/10		75.20000	75.20000		
25	Brenda Witakirua Single	f.	1/10		75.20000	75.20000		
26	Patrick Te Ngairo Waihaki	m.	1/10		75.20000	75.20000		
27	Matekino Reid	f.	1/10		75.20000	75.20000		
ENTERED BY [Signature]				CHECKED BY [Signature]				

M.A. 835

74210H-10,000/7/87 MK

M.A. 801

SCHEDULE OF OWNERSHIP ORDERS

TITLE: P.O. dated 3.11.1952

BLOCK: Whangawehi BSB28 AREA: 12.6287ha SHARES: 4912.0000

(The orders themselves should be referred to for search purposes)

List No.	Owners	Sex and Age	Ratio	Shares in Block			Total	To	
				Already Owned		Now Acquired Number			
				From	Number				
				Maata or Mata Waihaki					
				DECEASED OR TRANSFEROR					
				LIST No.	11	SPR	1040.0000	98	Waihaki M.B. REF. 214
				ORDER	Sec. 113 & 118/95		DATE	3.3.98	
28.	Aroha Maata Te Hau	f.	1/2				520.50000	520.00000	
29.	John William Panther		1/2				520.50000	520.00000	
				ENTERED BY <i>AB</i> CHECKED BY <i>fl</i>					
				Hiria Waihaki					
				DECEASED OR TRANSFEROR					
				LIST No.	5	SPR	1040.00000	98	Waihaki M.B. REF. 161
				ORDER	Sec. 118/93		DATE	3.6.98	
30.	Rehi Elizabeth Moore	F	1/5				208.00000		
31.	Tihema Taurima	M	1/5				208.00000		
32.	Hiria Gail Celia Taurima - Te Ngā	F	1/5				208.00000		
33.	Raniera Daniel Taurima	M	1/5				208.00000		
34.	Estalei Lei Taurima Poynter	F	1/5				208.00000		
				ENTERED BY <i>AB</i> CHECKED BY <i>AB</i>					
				M.A.S.					

M.A. 835

7421MH-10,000/7/87 MK

SCHEDULE OF OWNERSHIP ORDERS

Total Area: 12.6337 Ha. Page No. 1
45608

TITLE: P/O 3.11.52
BLOCK: WHANGAREI 1B5B2B

NUMBER OF ORIGINAL OWNERS: 5

AREA: 30.2320

SHARES: 4912.000

(The orders themselves should be referred to for search purposes)

List No.	Compiled as at 3.11.52	Sex and Age	Ratio	Shares in Block			Total	To
				Already Owned From	Number	Now Acquired Number		
1.	Ani Waihaki	f.					1040.000	
2.	Hiria Waihaki	f.					1040.000	
3.	Karauria Waihaki	m.					752.000	6
4.	Maata or Mata Waihaki	f.	15-3-8				1040.000	
5.	Rapata Toko or Rapata Toko Waihaki	m.					1040.000	8-20
	Typing checked: <i>[Signature]</i>							8
	CORRECTED 10 Hiri						4912.000	20
	14.9.76							
				DECLARED	Karauria Waihaki			
				LIST No. 3	SHARES 752.000 M.B.	REF. Page 10/20		
				ORDER Dec 81 (2) / 1967		DATE 17/10/63		
6.	Rangi Waihaki As Administratrix of the Estate of Karauria Waihaki deceased				752.000	752.000	752.000	7
				ENTERED BY MP	CHECKED BY <i>[Signature]</i>			
				DECLARED	Rangi Waihaki As Admin of the Est of Karauria Waihaki			
				LIST No. 6	SHARES 752.000 M.B.	REF. Page 10/8		
				ORDER Dec 81 (6) / 1967		DATE 27.1.84		
7.	Rangi Waihaki For the or ush marriage with remainder to:- Pera Waihaki Peratiaki Waihaki Mihikite Kapua Vanderchaegue Iama Anohani Waihaki Makeatanga Waihaki Tewai Topa Nathan Alexa Merita Rauhiha Spark Brenda Wihakina Single Patrick Te Ngao Waihaki Matekino Retol EQUALLY			of Solely	-	752.000	752.000	
				ENTERED BY <i>[Signature]</i>	CHECKED BY <i>[Signature]</i>			

SCHEDULE OF OWNERSHIP ORDERS

FILE: Partition Order Dated 3.11.52

BLOCK: WHANGAREHI 1B5B2B..... AREA: 12.63372 ha..... SHARES: 4912.000.....

(The orders themselves should be referred to for search purposes)

List No.	Owners	Sex and Age	Ratio	Shares in Block			Total	To
				Already Owned		Now Acquired		
				From	Number			
<p align="center">DECEASED OR TRANSFEROR <u>Rapata Toko or Rapata Tok</u> <u>Waihaki</u> <u>86 071</u> LIST No. <u>5</u> SHARES <u>1040.000</u> M.B. REF. <u>101-102</u> ORDER <u>Sec 78A/67</u> DATE <u>1984</u></p>								
8	Rapata Matemoana Toko	m.d.	1/13		80.000	80.000		
9	Theresa Toko	f.a.	1/13		80.000	80.000		
10	Douglas Martin Toko	m.a.	1/13		80.000	80.000		
11	Junette Francis Holt	f.a.	1/13		80.000	80.000		
12	William Claude Toko	m.a.	1/13		80.000	80.000		
13	Fay Marie Toko	f.a.	1/13		80.000	80.000		
14	Iritana Terauaroa Holt	f.a.	1/13		80.000	80.000		
15	Reginald Peter Toko	m.a.	1/13		80.000	80.000	21	
16	McGregor Toko (16.4.67)	m.b.	1/13		80.000	80.000	26	
17	Kevin Desmond Toko (17.5.68)	m.b.	1/13		80.000	80.000	22	
18	Albina Faith Toko (20.11.69)	f.b.	1/13		80.000	80.000	23	
19	James Andrew Toko (10.12.70)	m.b.	1/13		80.000	80.000	24	
20	Lily Cecelia Toko (6.10.72)	f.b.	1/13		80.000	80.000	25	
<p align="right">SIGNED BY <u>[Signature]</u> CHECKED BY <u>[Signature]</u></p>								
<p align="center">DECEASED OR TRANSFEROR <u>Reginald Peter Toko And Kevin Desmond Toko</u> <u>Whangarei</u> LIST No. <u>15917</u> SHARES <u>160.000</u> M.B. REF. <u>147/21-25</u> ORDER <u>sec 93/53</u> DATE <u>10.7.84</u></p>								
21	Reginald Peter Toko	m	-	-	80.000	80.000		
22	Kevin Desmond Toko	m.b.	(17.5.68)	-	80.000	80.000		
<p>TRUSTEE: Douglas Martin Toko</p> <p align="right">SIGNED BY <u>[Signature]</u> CHECKED BY <u>[Signature]</u></p>								

MA 535

80002H--10.000/8/82MK

On: 25.03.01 Road Stale.
and removed 23.4.83

VALUATION AND PLAN (REF NO 8700/449) MEMORIAL SCHEDULE

WHANGAREHI 1B5B2B

NAME OF BLOCK:

N.B. - The order or title notice should be referred to for search purposes.

Nature of Order or Instrument	Date	Checked	Reference
Propn. Crown Survey Liens £7.1.2.4 as from	31.10.16		MA8/3/528 F.162
plus interest £11.4.11.4 " " "	7.12.23		
Order stopping road amending boundaries and revesting			
0:2:03p. in the owners	23.9.53		Wr. 55/145
Subject to part XXIV/1953	8.7.71		N.Z. Gaz 52 Page 1366
Propn. Succn. Duty £3.19.4 re Pera Waihaki or			
Karauria deed in 1B5B2	30.6.38		Wr. 46/79
Pt. (30.2.30) leased to N.B. King 21 yrs from	1.1.63		Memo 3203
Typing checked: <i>CH</i>			
Notice of Release of Lien	6.3.72		Memo 8342
Recommendation to set land apart as a Maori			
Reservation, seaward severance of 2833m ²	23-11-78		Wr. 78/105
Rate Charging Orders to remain on the main			
part of block - (not on the part covered by the	24-3-79		Memo 11519
Sec. 439 Reservation)			
Pt 2833m ² declared Maori Reservation N.Z.			
Gazette 19-4-79 No. 31 page 1147	2-5-79		Memo 11547
Order Sec. 439(7)/53 Vesting in trustees	4-5-79		Wr. 78/244
Trustees Appointed at W.M.B. 78/244			
Karauria Waihaki	m D. of MAHIA Freezing Worker		
Huia Rangiora Greening	f of MAHIA Housewife		
Celia Taurima	f of Maraenui MAHIA Widow		
Order Sec 438(2)/53 Vesting in the Maori			
Trustee <i>on</i>	1.4.82		Wr M.B. 81/89-90
Order Sec 438(5)/53 setting out terms of			
Trust <i>dated</i>	1.4.82		Wr M.B. 81/89-90
Order Sec. 438(3)(c)/53 that the trust be terminated			
and the land be hereby vested in the persons			
beneficially entitled as tenants in common in their			
respective shares. Dated	18.8.83		Wr 82/27
Released from Part xxiv/1953	26.2.85		N.Z. GAZZ 18
Sec. 438(2)/53 vesting in: Ani Byron, Gordon Byron			pg 402 Memo.
Celia Taurima, Rangi Waihaki and			15378
Sec. 438(5)/53 setting out the terms of the			
trust. Dated 23.11.84	15.11.85		82 Wr 366

MEMORIAL SCHEDULE

Page 2

NAME OF BLOCK:Whangawehi 1B5B2B.....

N.B. - The order or title notice should be referred to for search purposes.

[illegible]

RATE CHARGING ORDER SCHEDULE

VALUATION SHEET

BLOCK: WHANAWAHEI 18522B DISTRICT: WAIROA
 AREA: 12.4239 ha TOTAL SHARES: 4912.0000
 SURVEY DISTRICT: BLK II MAHIA

VALUATION DETAILS

DATE: <u>1.7.88</u>	LAND:	IMPTS:	DETAILS	CAPITAL:	VALUE ONE SHARE
VALN REF:					
<u>8701/449</u>	<u>7000</u>	<u>5000</u>		<u>12000</u>	<u>\$</u>
<u>8701/449/1</u>	<u>1000</u>			<u>1000</u>	
TOTAL	<u>71000</u>	<u>50000</u>		<u>121000</u>	<u>\$ 24.6335</u>

Occupier (Within meaning of the rating act): _____ Checked: VP

DATE: <u>1.10.91</u>	LAND:	IMPTS:	DETAILS	CAPITAL:	VALUE ONE SHARE
VALN REF:					
<u>8701/449</u>	<u>44500</u>	<u>61000</u>	<u>OB; FG; DI</u>	<u>105500</u>	
<u>8701/449/1</u>	<u>1000</u>		<u>DWG</u>	<u>1000</u>	
TOTAL	<u>45500</u>	<u>61000</u>		<u>106500</u>	<u>\$ 21.6816</u>

Occupier (Within meaning of the rating act): 870/449 - Mahoe Waihaki Checked: VP

DATE: <u>1.9.96</u>	LAND:	IMPTS:	DETAILS	CAPITAL:	VALUE ONE SHARE
VALN REF:					
<u>8701/449</u>	<u>101000</u>	<u>104000</u>	<u>2 DWGS; OB; DI</u>	<u>205000</u>	
<u>8701/449/01</u>	<u>1500</u>		<u>FG</u>	<u>1500</u>	
TOTAL	<u>102500</u>	<u>104000</u>		<u>206500</u>	<u>\$ 42.0399</u>

Occupier (Within meaning of the rating act): _____ Checked: B.J.R

DATE: <u>1-9-97</u>	LAND:	IMPTS:	DETAILS	CAPITAL:	VALUE ONE SHARE
VALN REF:					
<u>8700/44900</u>	<u>115000</u>	<u>140000</u>	<u>2 DWGS</u>	<u>256000</u>	
<u>8700/44901</u>	<u>2000</u>		<u>OB</u>	<u>2000</u>	
			<u>OI</u>		
TOTAL	<u>117000</u>	<u>140000</u>	<u>FG</u>	<u>257000</u>	<u>\$ 52.32084</u>

Occupier (Within meaning of the rating act): _____ Checked: _____

DATE:	LAND:	IMPTS:	DETAILS	CAPITAL:	VALUE ONE SHARE
VALN REF:					
TOTAL					

Occupier (Within meaning of the rating act): _____ Checked: _____

3,000/6/60-24224 IV

17 OCT 1983

in Richard Andrews m. solely
 Ct Post Office, FERNHILL.

M.L.

17 OCT 1983

Appln 87163. Sec 81/67 Estate Tame Kana or Tame Takakino Kana Deed.
 Orders under Sec 81 were made at Repr AB 10/3-4 of 28 September 1983.
 Orders under Sec 81/67 are made in terms of the Will and the
 application filed vesting the interests held by the Maori
 Trustee, Gisborne as Administrator of the Estate of the
 deceased in:-

Herenga A22	74.41 shares	Herenga A23	514 shares
" A20	200 "	Naimalotini C B. Naiaia IA 1394	38.5816
" A16B	47.857 "	Ahikouka B10	36.237 shares

in
 Maria Te Mate Chorere Kana, f solely
 P.O. Box 157, RUATARA.

M.L.

17 OCT 1983

Appln 87165 Sec 81/67 Estate Karaurio Waihaki or Patrick Waihaki Deceased.
 Retired, Late of Mahia

The deceased died intestate on 29 July 1992. Letters of Administration
 (P.80/83) dated 15 April 1983 granted by the High Court, Gisborne.
 Accordingly, orders under Sec 81 are made vesting the shares of
 the deceased in:-

Whangawehi 18562B	752.000 shares	Whangawehi 18562A	238.000 shares.
-------------------	----------------	-------------------	-----------------

in
 Rangie Waihaki of Mahia, Widow as Administrator of
 the Estate of Karaurio Waihaki or Patrick Waihaki Deceased.

17 OCT 1983

Appln 87166 Sec 81/67 Haerepo Rangihaua Ngahere or Haerepo Harry
 Ngahere, Labourer, late of Rotorua.

The deceased died intestate on 29 November 1971. Letters of
 Administration (P.85/74) dated 20 February 1974, granted by the Supreme
 Court, Rotorua.

Accordingly orders under Sec 81 are made vesting the shares of the

17 OCT 1983

10 RGTA 85

27 JAN 1984

Whatatutu 2E1 250 shares

in

Mere Ngaira, f, 8 Smith Street, Waverly. ~~solely~~

27 JAN 1984

Appln 87448. Sec 81A/67. Estate Karauria Waihaki or Patrick Waihaki Deceased.

The orders under Sec 81/67 were made at Regt 10/20 f 17 October 1983.

There is an order under Section 81A in terms of the application filed vesting the interests held by Rangī Waihaki of Mahia as Administrator of the Estate of the deceased in:-
 Whangawehi 1B5B25 752,000 shares Whangawehi 1B5B2A 288,000

in

Rangī Waihaki f of Mahia, Widow, for life or until remarriage with remainder to:-

Pera Waihaki f

Peratiaki Waihaki m.

Matekino Reid f

Mihī Kite Kapua Vanderchaque f

Tama Arakani Waihaki m.

Maheātanga Waihaki m

Tewai Topsy Nathan f

Alexa Merita Raehina Spark f

Frenda Witakina Single f

~~Patrick~~ Te Ngaio Waihaki m.

Equally

27 JAN 1984

[Signature]
 Registrar
 27/1/84

NOV 1952

54

282 Whangamuri 18582

Parish

page
draw 43.

Inspection made by field supervisor.

all names present and agree upon the following variations:

Raised

Dec 30

Whangamuri 18582A - 1 a. 30. 00 h.

to be cut off in the lower eastern corner with a depth of 6 inches along the eastern boundary and a passage of 3 inches to the river road (Longman)

in front of:

Karamia Wairua

Raised

Dec 10

Whangamuri 18582B - 30 a. 20 32 h

Balance area in front of the remaining areas including Karamia Wairua for the balance of this area.

LAND DISTRICT HAWKES BAY
N.L.G. DISTRICT TAIRAWHITI
WAIROA COUNTY

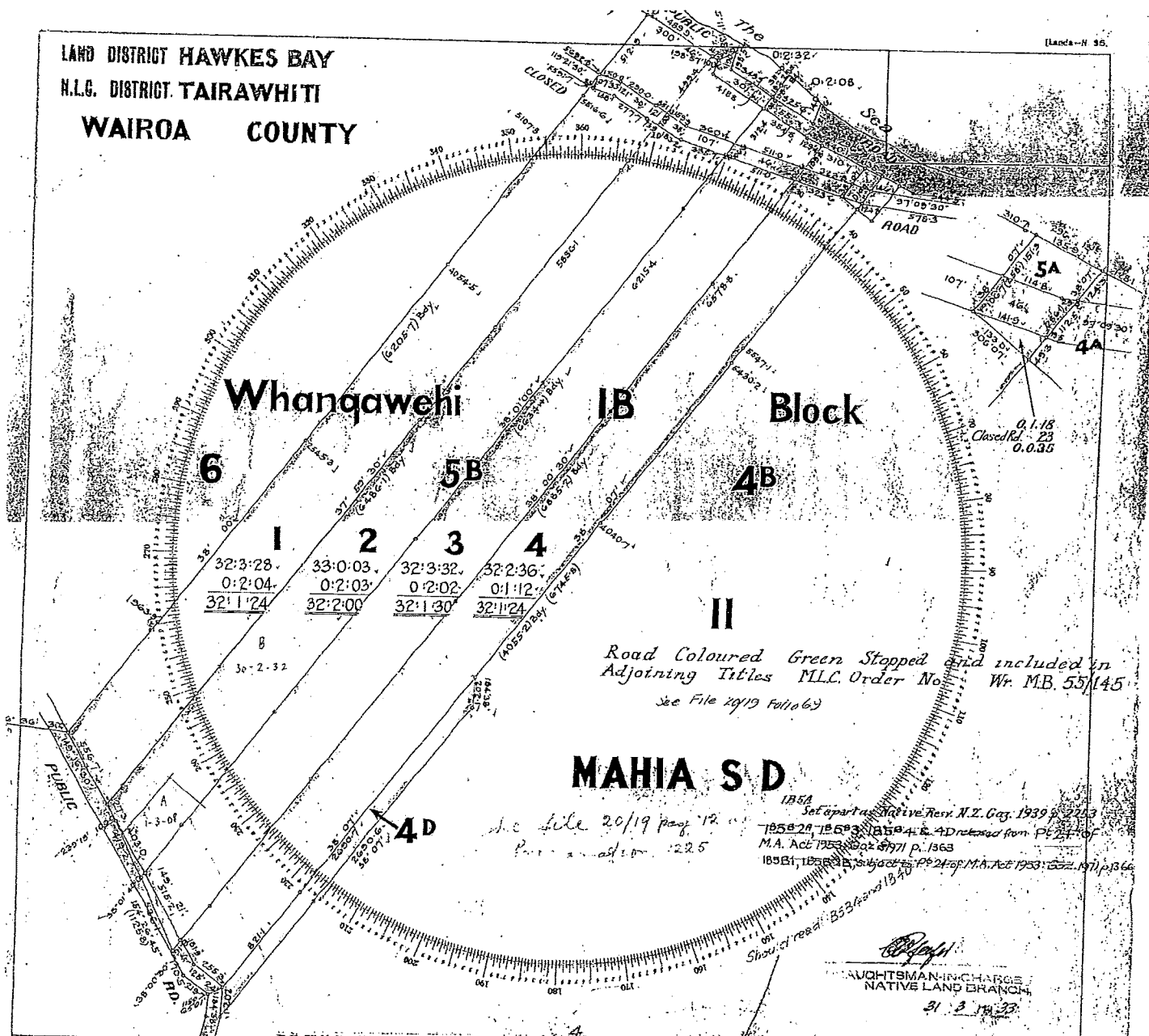

FILE :
AUTHORITY :
PARENT PLAN :
REF. PLANS: *Tracings. Photostat.*
Received :
Fieldbook :
Transfer-book :
Examined : *2/11/53*
Recorded :
Plan to write and ready for approval :

**WHANGAWEHI IB5B(1-3) IB5B4 4D & IB5A
BLOCK II MAHIA S.D.**

Surveyed by R. M. Mowat Date : November 1923
Registered Surveyor.

SCALES: CHAINS TO AN INCH
Robert Mowat, M.A. of the Surveyors' Association
Registered Surveyor hereby certifies that the plan has been made from surveys taken by him or under his supervision and that the plan and survey are correct, and have been made in accordance with the rules of the Survey Board.
Dated at Hawke's Bay this 25th day of March 1923
R. M. Mowat
Registered Surveyor.

Approved as from
Survey agrees with Court order.
J. R. Burrows
Chief Surveyor.

1400

PARTITION ORDER.

(Rule 87.)

The Native Land Act, 1909., and Sec. 55
Native Land Amendment Act, 1913.

WT. M.B. 33/288

IN THE NATIVE LAND COURT, } WHANGAWEHI. 1 B 5 A.
NEW ZEALAND.

Tairāwhiti District

In the matter of the partition of the land known as

Whangawehi 1 B 5 A & 5 B and
Whangawehi 1 B 4 D.

heretofore held

under Partition Orders, dated the 2nd. day
of September, 1921.

At a sitting of the Court held at Nuhaka
on the 26th day of March, 1923
before James Wakelin Browne, Esquire, Judge
and, Assessor.

It is, as part of the said partition, hereby ordered and declared that the
several persons whose names appear in the first column of the schedule endorsed
hereon or annexed hereto, and therein numbered from one to six
both inclusive, are the owners, in the relative shares or proportions set out
in the second column of the said schedule, of that part of the said land
containing 0 - 0 - 35, named by the Court

WHANGAWEHI. 1 B 5 A.

and which part is particularly delineated in the plan ordered hereto annexed.

As witness the hand of the Judge and the seal of the Court.

Order 30/- Paid



James Wakelin Browne

*Order 30/- road stopped
and resumed 23.9.23.*

THE SCHEDULE WITHIN REFERRED TO.

FIRST COLUMN.		SECOND.	
No.	Name.	Sex and (if Minor) Age.	Relative Int.
1.	Kerana Waihake	f.	3.
2.	Makoare Pepuere o.r. 25-10-59 1/2 s. Hemi te Puere	m.	1. 1/2
3.	Te Mini Keriana o.r. 1/2 s. Te Teira (Keriana)	f.	1. 1/2
4.	Pera Karauria s.s. Karauria Waihake	m.	3.
5.	Potahi Reupena o.r. 1/2 s. Te Teira (Keriana)	m.	1. 1/2
6.	Rangi Pepuere o.r. 1/2 s. Hemi te Puere	m.	1. 1/2
			12. shares.

Rate Charge of £ 1 10/2 applied for 6/8-30
granted : 26/2 3/.

as from

DUPLICATE FORWARDED FOR
REGISTRATION ON: 5/3/97

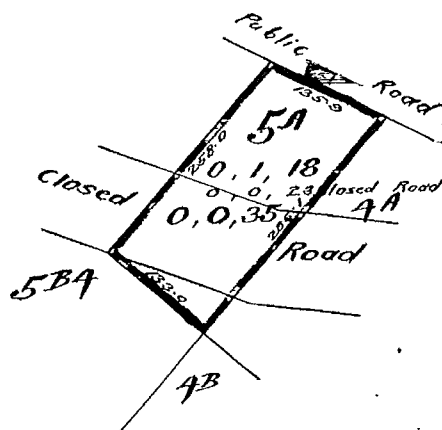

Whangwahi 1B Block

Mahia S. D.

II

E. W. G.

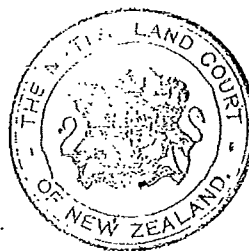

Surveyed by Mowat & Green
Chief Surveyor: J. P. Thomson
Draftsman: Amel
Scale: 5 Chains to an Inch.
Plan 1400

1000

PARTITION ORDER.

(Rule 37.)

The Native Land Act, 1909.

IN THE NATIVE LAND COURT,
NEW ZEALAND.

Whangawehi District

Whangawehi B. 5 A

Whangawehi B. 5 B

In the matter of the partition of the land known as

Whangawehi B. 5

heretofore held

under Decree of Validation Court, dated the 27th day
of October 1897.

Wm 25/189.

At a sitting of the Court held at

Tuhaka

on the

2nd

day of

September

1915

before

Robert Noble Jones

Esquire, Judge,

and

Assessor:

It is, as part of the said partition, hereby ordered and declared that the
several persons whose names appear in the first column of the schedule endorsed
hereon or annexed hereto, and therein numbered from one to 8

both inclusive, are the owners, in the relative shares or proportions set out
in the second column of the said schedule, of ~~that~~ ^{those} part of the said land,

together
containing

130 acres.

, named by the Court

Whangawehi B. 5 A 1

Whangawehi B. 5 B 1

and which part is particularly delineated in the plan endorsed hereon annexed

FEES CHARGED:

Wd 24 ypd
Order, 20/1

As witness the hand of the Judge and the seal of the Court.

[Signature]
Judge

Divided with B. 5 A 1/2

Whangawehi Block 5 A
 Whangawehi Block 5 B BLOCK.

(N.L.O. - 76)

THE SCHEDULE HEREINBEFORE REFERRED TO.

First Column.		Second Column.
Name.	Sex and, if Minor, Age.	Relative Interest.
✓ <u>Hemi Puere</u> as to share Rivia Wharepaiti m.	m.	1
2 ✓ <u>Karawia Waihake</u> as to share Rivia Wharepaiti m.	m.	2
3 ✓ <u>Kerana Waihake</u> as to share Rivia Wharepaiti f.	f.	2
4 ✓ <u>Makoare (Pepuere)</u> as to share Rivia Wharepaiti m.	m.	1
5 ✓ <u>Mini Keriana</u> as to share Rivia Wharepaiti f.	f.	1
6 ✓ <u>Potahi Reupena</u> as to share Rivia Wharepaiti m.	m.	1
7 ✓ <u>Rangi (Pepuere)</u> as to share Rivia Wharepaiti m.	m.	1
8 ✓ <u>Leina (Keriana)</u> as to share Rivia Wharepaiti m.	m.	1
Total		<u>12 shares</u>

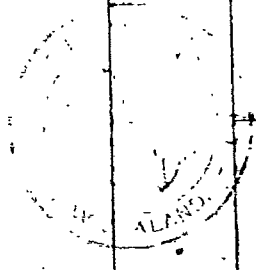

— 28 —

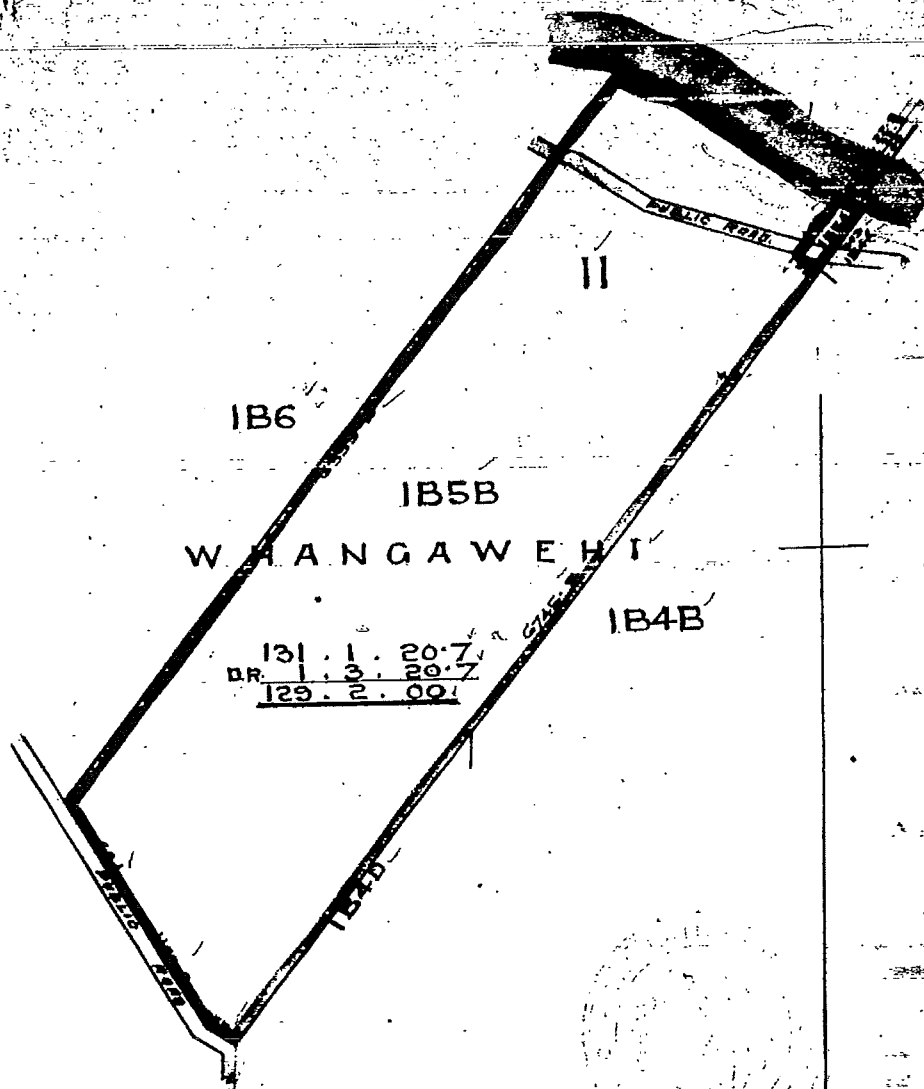

Surveyed by A.G. Saxby -

Chief Surveyor W.F. Marsh

Draughtsman *[Signature]*
 2nd (2nd) Floor, 12/47
 Plan 255

TRUSTEE ORDER

PARTITION ORDER

(RULE 37)

The Maori Land Act, 1931

Wr. M.B. 54 / 54

IN THE MAORI LAND COURT
NEW ZEALAND.
Tairāwhiti DISTRICT.

WHANGAWEHI 1B5B2B BLOCK

In the matter of the partition of the land known as

Whangawehi 1B5B2 heretofore held
under partition order, dated the 26th day
of March, 19 23

AT a sitting of the Court held at Nuhaka
on the 3rd day of November, 19 52
before Norman Smith Esquire, Judge.

It is, as part of the said partition, hereby ordered and declared that the
several persons whose names appear in the first column of the schedule endorsed
hereon ~~or annexed hereto~~, and therein numbered from one to five
both inclusive, are the owners, in the relative shares or proportions set out in the
second column of the said schedule, of that part of the said land, containing
12.351 ha (30a: 2r: 31p) named by the Court

W H A N G A W E H I 1B 5B 2B

and which part is particularly delineated in the plan attached hereto.

FEES CHARGED: As witness the hand of the Judge and the seal of the Court.
Order 10/- paid On this 17th day of February 2009

Oa: 2r. 03. 0p. road stand
and reserved 23.9.53



Judge.
(W W 1894C)

Subject to Part I Maori Land Amendment Act, 1936.



THE SCHEDULE WITHIN REFERRED TO

FIRST COLUMN.			SECOND COLUMN.
No.	Name.	Sex and (if Minor) Age.	Relative Interest.
1.	Ani Waihaki 1/6s. Pera Waihaki or Pera Karauria o.r. 1/5s. Rihī Waihaki 1/6s. Pera Waihaki or Pera Karauria o.r.	f.a.	1040 Shares
2.	Hiria Waihaki as for No.1	f.a.	1040
3.	Karauria Waihaki (Balance of Interest) as for No.1	m.a.	752
4.	Maata or Mata Waihaki as for No.1	f.20	1040
5.	Rapata Toko or Rapata Toko Waihaki as for No.1	m.18	1040
TOTAL:			4912 <u>SHARES</u>



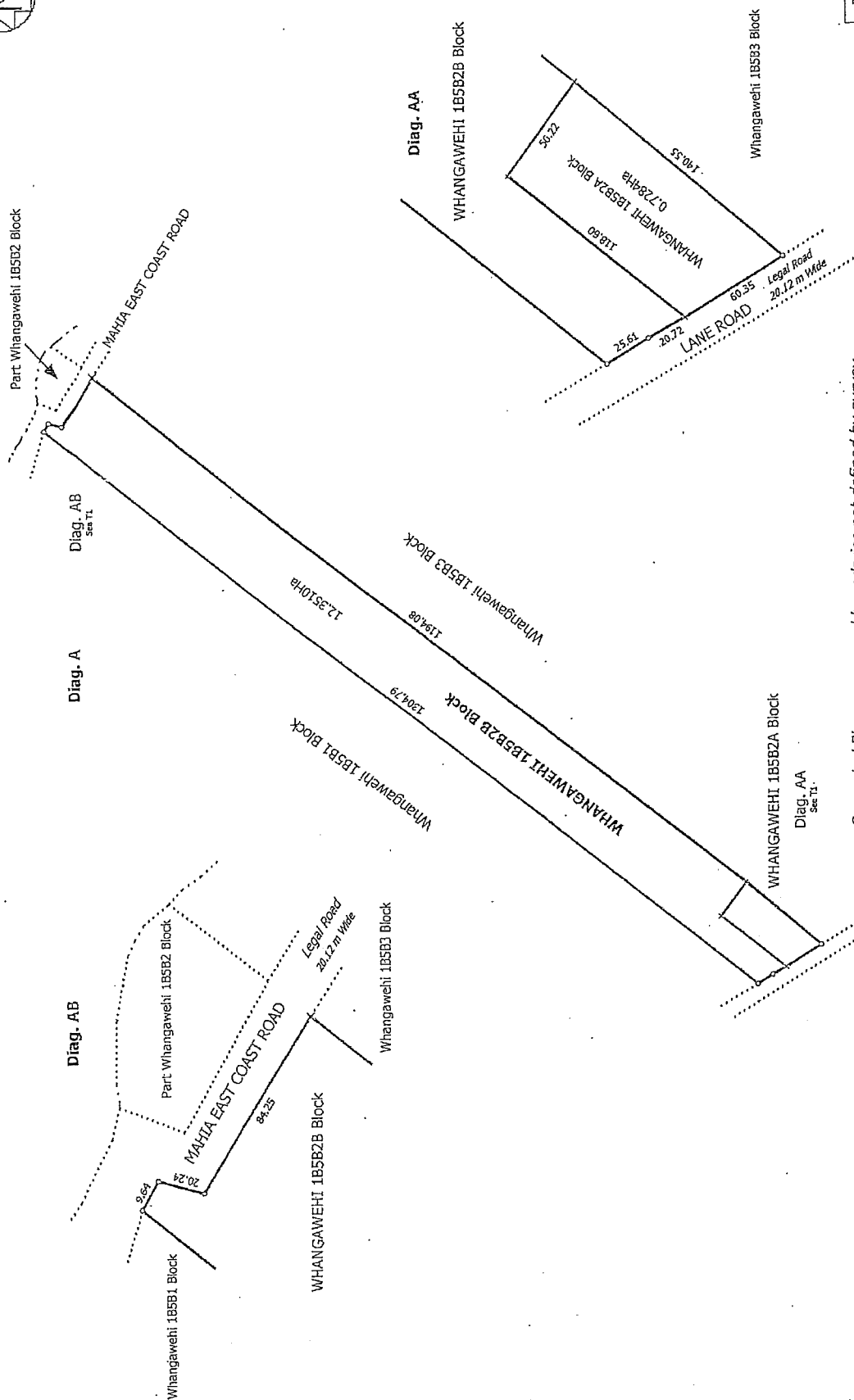

Computed Plan - areas and boundaries not defined by survey

T1/1

Land District: Hawkes Bay Dataset Type: Computed Digitally Generated Plan Generated on: 02/04/2008 2:32pm Page 2 of 2	WHANGAWEHI 1B5B2A and 1B5B2B Block Surveyor: Philip Dudley Norton Firm: Ensurv	Digital Title Plan ML 398933 Approved on: 2/04/2008
--	--	---

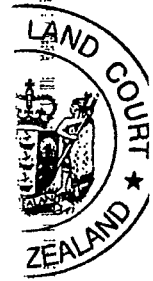

CERTIFICATE OF APPROVAL FOR DIGITAL SURVEY PLAN

ML Plan No: ML 398933

Block: Whangawehi 1B5B2A and Whangawehi 1B5B2B

Approval

Tairawhiti Maori Land Court District

Approved:

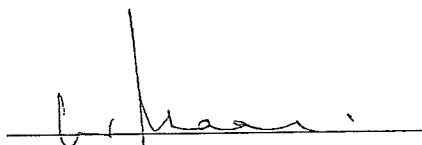

Judge

Date: 17 February 2009

Minute Book Reference: 54 Wairoa MB 54

Date of Orders: 3 November 1952

Total Area:

Whangawehi 1B5B2A:	0.7284 ha	(1a:3r:8p)
Whangawehi 1B5B2B:	12.351 ha	(30a:2r:3.1p)

In terms of the standards for digital title plans the following notation is recorded:

"Computed plan – area and boundaries not defined by survey"

As this plan has not been defined by survey the approval is not sufficient to support the issue of a full title.

Comprised in: ML 398933

District Council: Wairoa